



# 9000M2 PAGING ACCESSORIES



*Convenient paging to a maximum of 12 speaker zones*

TOA Q-RM9012 Remote Microphone is designed to efficiently select desired speaker zones in a public address system and is easy to interface with different system by connecting the 12 dry contact control signals. By using Q-RM9012, up to 12 speaker zones for paging can be selected. Depending on whether a Zone Selector button, or the All-Call button is pushed, message broadcast to all zones or individual zones can be achieved. Besides, a Clear button is also designed to clear all selection at one touch to facilitate easy operation. LED beside each button shows the status of each zone allows operator to understand situation of each zone at a glimpse. All in all, Q-RM9012 facilitates flexible zone paging and operation.

### FEATURES

- Unidirectional electret condenser microphone with balanced audio output
- An All-call Button for selecting all zones
- A Clear Button for clearing all zone selections
- Announcement to the selected zones out of a maximum of 12 zones
- LED indicator for each selector
- Paging zones may be selected individually or in groups
- All connections to amp/speaker selector via shielded CAT5 cable
- May be used with 9000M2 with version 2.0 software/firmware
- AD-246 Power Supply included

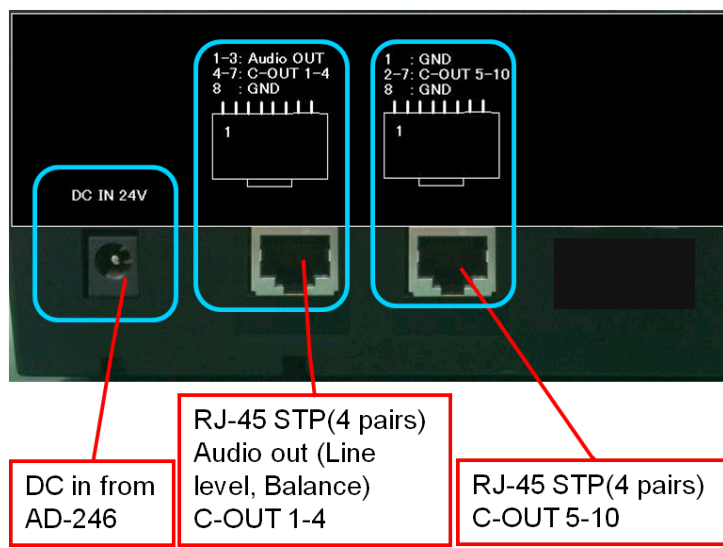
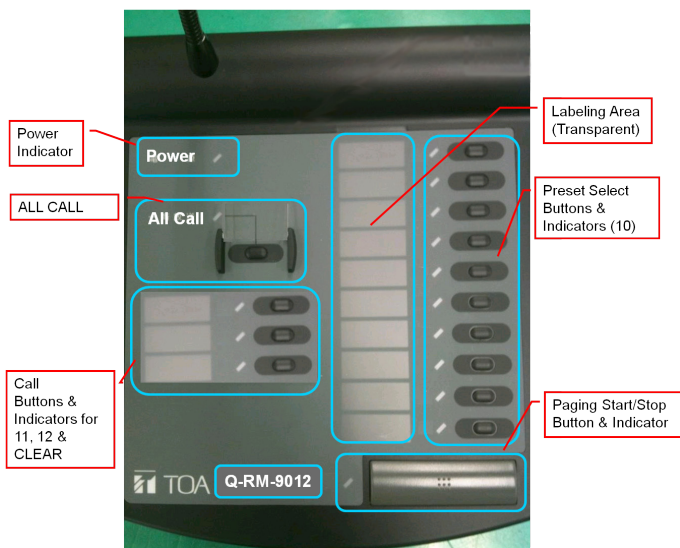

Power Source	24 V DC from AC adaptor AD-246 or equivalent
Power Consumption	80mA or less
Audio Output	0 dB (*1), 600 Ohms, transformer balanced, RJ45 connector
Distortion	1% or less
Frequency Response	100 - 20,000Hz
S/N Ratio	60dB or more
Microphone	Unidirectional electret condenser microphone
Control Output	12 channels, open collector output, withstand voltage: 27V DC, control current: max. 50 mA, (2) RJ45 connectors
Number of Keys	12 zone selection keys, All call key, Cancel key, Talk key
Volume Control	Microphone volume control
Operating Temperature	-10C to + 40C (14F to 104F)
Finish	ABS resin, Black
Dimensions	190 W x 76.5 H X 215 D mm (Gooseneck microphone excluded)
Weight	750g
Supplied Accessory	AC Adaptor: AD-246

TOA Q-SS-9012PS is a speaker selector used in conjunction with the 9000M@ Series Mixer Amplifiers. It selectively distributes each of 2 amplified inputs to the same 12 output zones by the status of corresponding contact closure input. It requires the DC 24V power supply (AC Adaptor, AD-246 or equivalent).

## FEATURES

- 12 contact inputs and 12 speaker outputs. Power amp input is split into 12 zones with activation via contact closure
- Possible to expand number of 9000M2 paging zones along with conventional output zones (T-001T) up to 19 zones
- Can facilitate paging over BGM by switching between BGM output (amp input 2) and Page output (amp input 1)
- May work with internal or external amplifier
- 19" rack-mountable (using optional MB-15B)
- Supplied with AD-246 AC Adapter

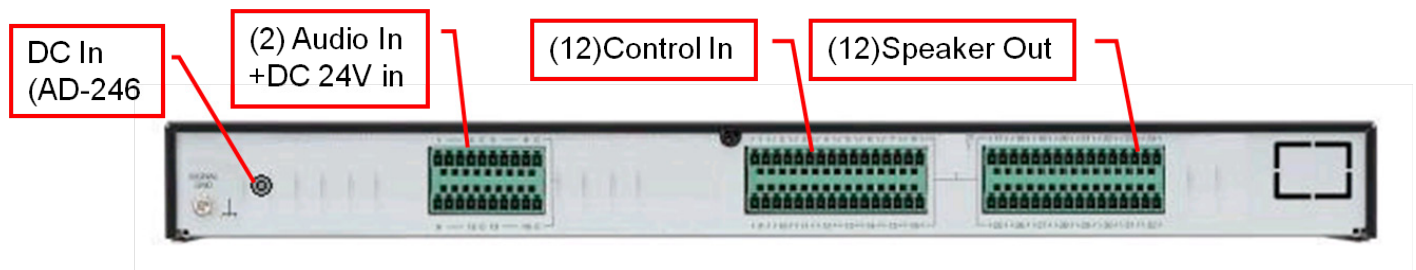

Power Source	24 V DC from AC adaptor AD-246 or equivalent
Power Consumption	400mA or less
Power Handling	250W or less (70V/100V line) per channel (IN1, IN2)
Control Input	12 channels, dry (no voltage) contact closures, open voltage: 3.3V DC, short-circuit current: under 1 mA, removable terminal block (24 pins)
Speaker Terminal	Removable Terminal Block (2 pins, IN1, IN2, Zone1 - 12)
Control Terminal	Removable Terminal Block (24 pins_
Operating Temperature	-10C to +40C (14F to 104F)
Finish	Case: Surface-treated steel plate, Black
Dimensions	420 W x 44 H x 123 D mm
Weight	1.6kg
Accessory	Removable Terminal plug (2pins) Removable Terminal Plug (12 pins) Removable Terminal Plug (14 pins)
Supplied Accessory	AC adaptor: AD-246
Options	Rack mount bracket: MB-15B, Wall mount bracket: YC-850

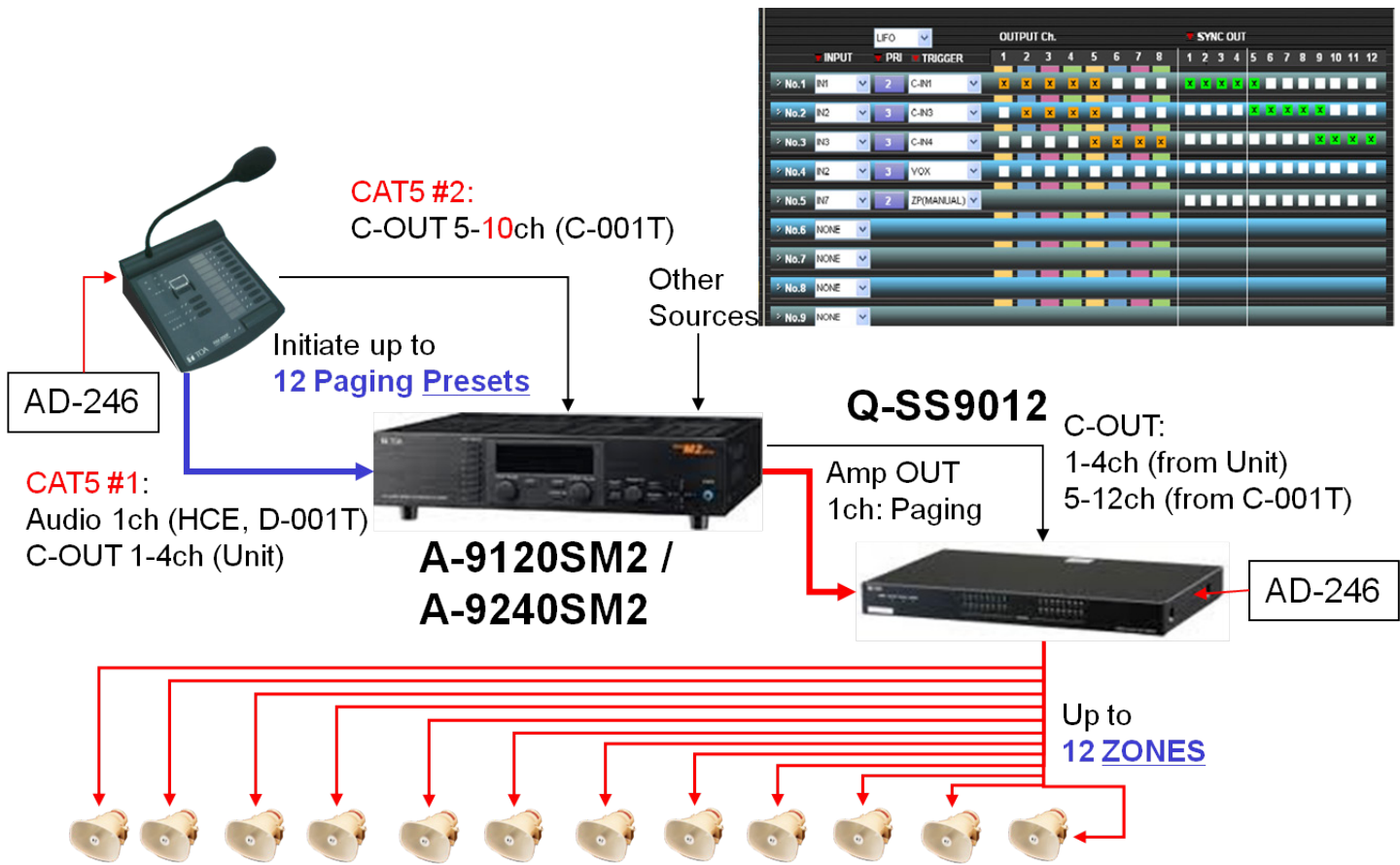

LFO	INPUT	PRI	TRIGGER	OUTPUT Ch.								SYNC OUT										
				1	2	3	4	5	6	7	8	1	2	3	4	5	6	7	8	9	10	11
No.1	IN1	2	C-IN1	X	X	X	X	X	X	X	X	X	X	X	X	X	X	X	X	X	X	X
No.2	IN2	3	C-IN3	X	X	X	X	X	X	X	X	X	X	X	X	X	X	X	X	X	X	X
No.3	IN3	3	C-IN4	X	X	X	X	X	X	X	X	X	X	X	X	X	X	X	X	X	X	X
No.4	IN2	3	VOX																			
No.5	IN7	2	ZP(MANUAL)																			
No.6	NONE																					
No.7	NONE																					
No.8	NONE																					
No.9	NONE																					

9000M2 v2.0 GUI Software

9000 M2 Series Programming Software - B.m2

File Setting Option Communication Help

CURRENT SCENE NO: ...

1.16/17.32 POWER ON DEL

Scene List:

- No.01 SCENE1
- No.02 SCENE2
- No.03 SCENE3
- No.04 SCENE4
- No.05 SCENE5
- No.06 SCENE6
- No.07 SCENE7
- No.08 SCENE8
- No.09 SCENE9
- No.10 SCENE10
- No.11 SCENE11
- No.12 SCENE12
- No.13 SCENE13
- No.14 SCENE14
- No.15 SCENE15
- No.16 SCENE16
- LAST

Channel Settings:

Ch	IN	PRI	VOL	EQ	COMP	GATE
Ch.1	IN1	2				
Ch.2	IN2	3				
Ch.3	IN3	3				
Ch.4	IN4					
Ch.5	IN5					
Ch.6	IN6					
Ch.7	IN7	2				
Ch.8						

Routing Matrix (OUTPUT Ch. 1-12):

INPUT	PRI	TRIGGER	1	2	3	4	5	6	7	8	1	2	3	4	5	6	7	8	9	10	11	12
No.1	IN1	2	C-IN1	X	X	X	X	X	X	X	X	X	X	X	X	X	X	X	X	X	X	X
No.2	IN2	3	C-IN3	X	X	X	X	X	X	X	X	X	X	X	X	X	X	X	X	X	X	X
No.3	IN3	3	C-IN4	X	X	X	X	X	X	X	X	X	X	X	X	X	X	X	X	X	X	X
No.4	IN2	3	VOX																			
No.5	IN7	2	ZP(MANUAL)																			
No.6	NONE																					
No.7	NONE																					
No.8	NONE																					
No.9	NONE																					

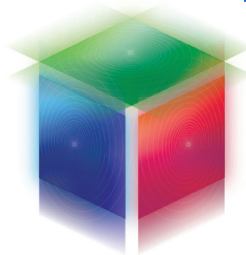

Human Society with  
Sound & Communication

TOA Electronics, Inc.  
www.toaelectronics.com  
Specifications subject to change without notice.